

Light Source Specification

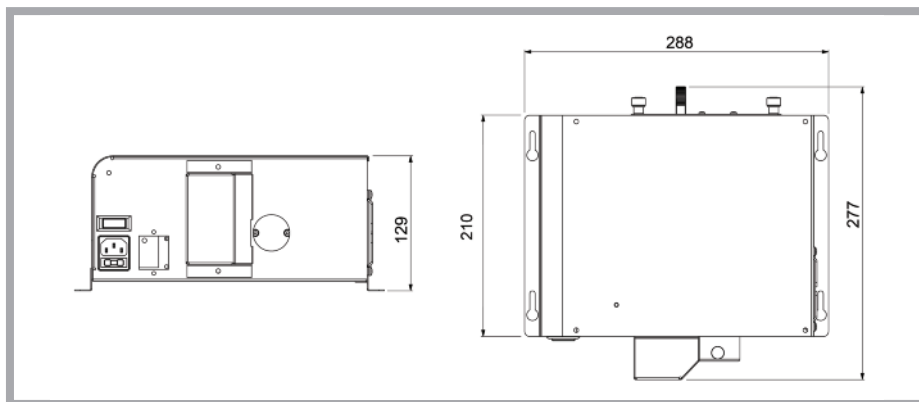

Compact Decorative Metal Halide Light Source

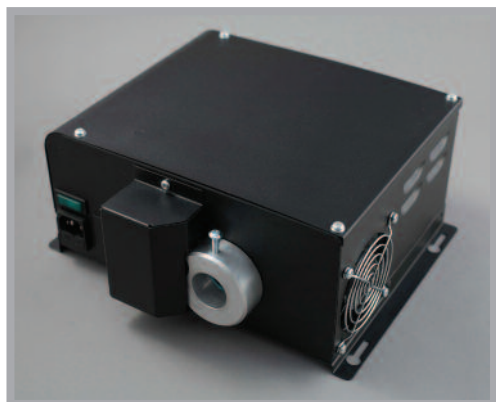

A low profile light source which uses either a 70W or a 150W metal halide discharge lamp to give much greater brightness than those powered by halogen lamps.

This model has a fast re-lamping feature (the lamp is mounted on a pull-out hatch on the rear) and comes fitted with either a colour, twinkle or dimmer wheel. Wheel control is either single feed - where the wheel rotates continuously, separate feed - where the wheel is controlled by an additional electrical supply or by a switch on the box.

Description	70W	150W
Port connector size	30mm diameter	30mm diameter
Fibre type	Glass/Polymer	Glass/Polymer
Supply voltage	120/240 VAC 50/60 Hz	120/240 VAC 50/60 Hz
Lamp power	70W	150W
Input power	144VA @ 240VAC	180VA @ 240VAC
Start up current	0.25A (240V) / 0.39A (120V)	0.3A (240v) / 0.7A (120V)
Running current	0.6A (240V) / 0.73A (120V)	0.75A (240V) / 1.5A (120V)
Min. ambient temperature	-20°C	-20°C
Max. ambient temperature	40°C	40°C
Thermal protection	Thermal switch	Thermal switch
Ballast type	Electronic	Electronic
Fan type (polymer fibre)	Papst 8550N	Papst 8550N
Fan type (glass fibre)	Papst 8880N	Papst 8880N
Fan type (120V models)	Papst 8800N (polymer fibre) Papst 8830N (glass fibre)	Papst 8800N (polymer fibre) Papst 8830N (glass fibre)
Power cord	IEC mains cable	IEC mains cable
Main fuse	4 Amp	4 Amp
Lamp type	Metal halide	Metal halide
Lamp model	Philips CDM-T or CDM	Philips CDM-SA/T or CDM
Lamp life	c. 9000h	c 6000h
Lamp colour temperature	4200K(CDM-T)/3000k(CDM)	4200K(SA/T)/3000k(CDM)
Lamp CRI	96 (CDM-T) / 85 (CDM)	96 (SA-T) / 84(CDM)
Acoustic rating (polymer fibre)	38.0 dB(A)	38.0 dB(A)
Acoustic rating (glass fibre)	23.0 dB(A)	23.0 dB(A)
Operating environment	Indoor / dry	Indoor / dry
Protection rating	IP20	IP20
Material	Sheet steel	Sheet steel
Colour	Black	Black
Size	288 x 277 x 129 mm	288 x 277 x 129mm
Weight	3.5kg	3.5kg



For current specification part numbers, please see the light source configuration tool on our website.